

Floresta

4-5 Bedroom / 3-4 Bathroom / 3-5 Car Garage / 2,001 ft.²

Delve into a realm of enhanced versatility with the Floresta. This exquisite two-story dwelling beautifully integrates open-concept living with thoughtful design details for a seamless living experience. The first floor hosts a welcoming guest suite, providing a private and comfortable space for visitors.

Floor Layout Options:

- 5 Car Garage w/ Door To Yard
- Unfinished Basement
- Finished Basement
- Add Door From Garage To Yard
- Expanded Garage - Rear Door 8' x 8'

Upgrade Options:

- 10 Interior Packages to Choose From
- 4 Fireplace Options to Choose From
- A/C
- Laundry Upgrade - Sink & Cabinets
- Window Coverings Throughout
- BBQ Gas Stub To Rearyard
- Metal & Trex Deck 12' x 20'
- Electric Upgrade 1
 - Solar Conduit to Roof & EV Pre-wire
- Electric Upgrade 2
 - Electrical panel upgrade, holiday lights, can lights, undercabinet lights and more
- Finished Upgrades
- Kitchen Appliance Package



CRAFTSMAN



PRARIE W/ 5 CAR GARAGE



LEARN MORE ABOUT THE FLORESTA



CONTACT US TODAY!

(719) 800-9822

SALES@MAYBERRYCOLORADOSPRINGS.COM
WWW.MAYBERRY-COLORADO.COM

SECOND FLOOR

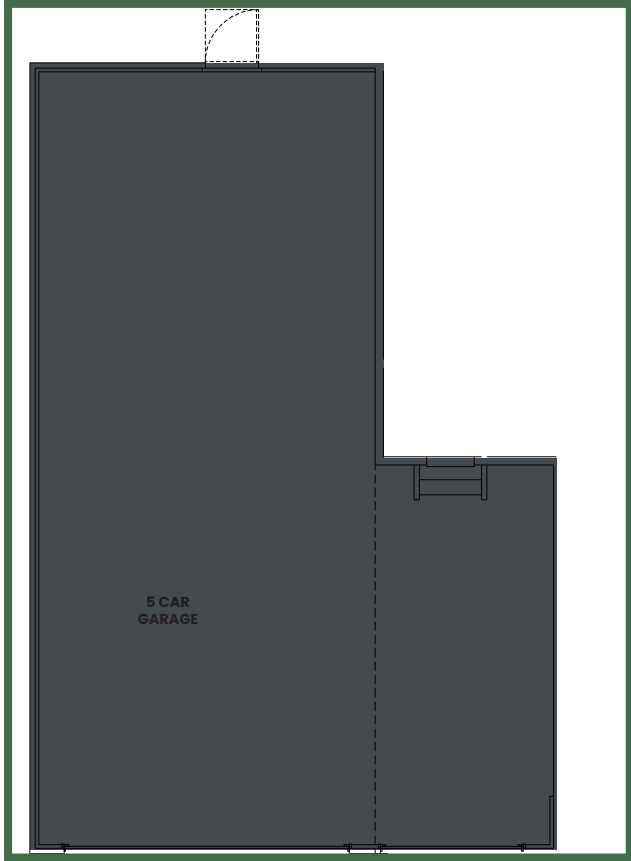
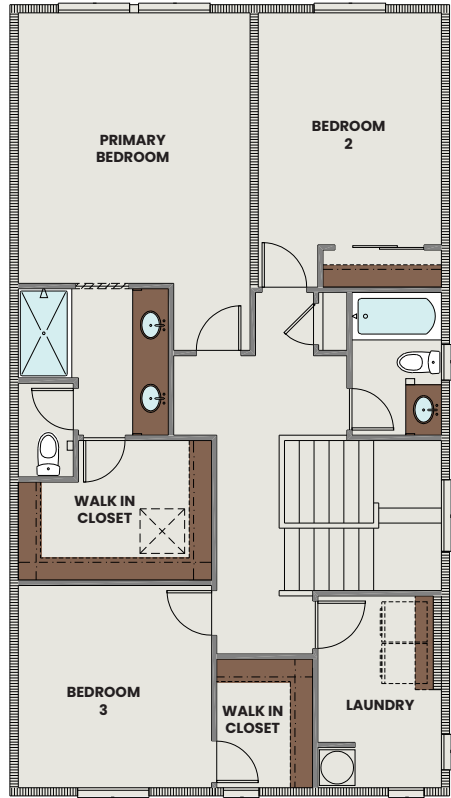

FIRST FLOOR

