

# Roseland

3-7 Bedroom / 3.5-5.5 Bathroom / 3-5 Car Garage / 3,247 ft.<sup>2</sup>

Delve into the Roseland, an extraordinary embodiment of timeless charm interwoven with innovative design. This exquisite floor plan strikes a balance between comfort and sophistication, assigning space thoughtfully to create areas that resonate with your lifestyle needs.

## Floor Layout Options:

- 3 Garage Options to Choose From
  - STD 3 Car Garage
  - 4 Car Garage w/Door to Yard
  - RV Garage w/Door to yard
- Multi-Gen Suite
- Unfinished Basement (292 Sq. Ft.)
- Finished Basement (1,082 Sq. Ft.)
- Expand Primary Bedroom and Remove 4th Bedroom
- Add Door From Garage To Yard
- Expanded Garage - Rear Door 8' x 8'

## Upgrade Options:

- 10 Interior Packages to Choose From
- 4 Fireplace Options to Choose From
- A/C
- Laundry Upgrade - Sink & Cabinets
- Window Coverings Throughout
- BBQ Gas Stub To Rearyard
- Electric Upgrade 1
  - Solar Conduit to Roof & EV Pre-Wire
- Electric Upgrade 2
  - Electrical panel upgrade, holiday lights, can lights, undercabinet lights, and more
- Finish Upgrade
- 7 Kitchen Appliance Packages to Choose From
- Rear Covered Patio



FARMHOUSE W/ RV GARAGE



FARMHOUSE W/ MULTI-GEN SUITE



LEARN MORE  
ABOUT THE ROSELAND



**CONTACT  
US TODAY!**  
(719) 800-9822

SALES@MAYBERRYCOLORADOSPRINGS.COM  
WWW.MAYBERRY-COLORADO.COM

# FIRST FLOOR

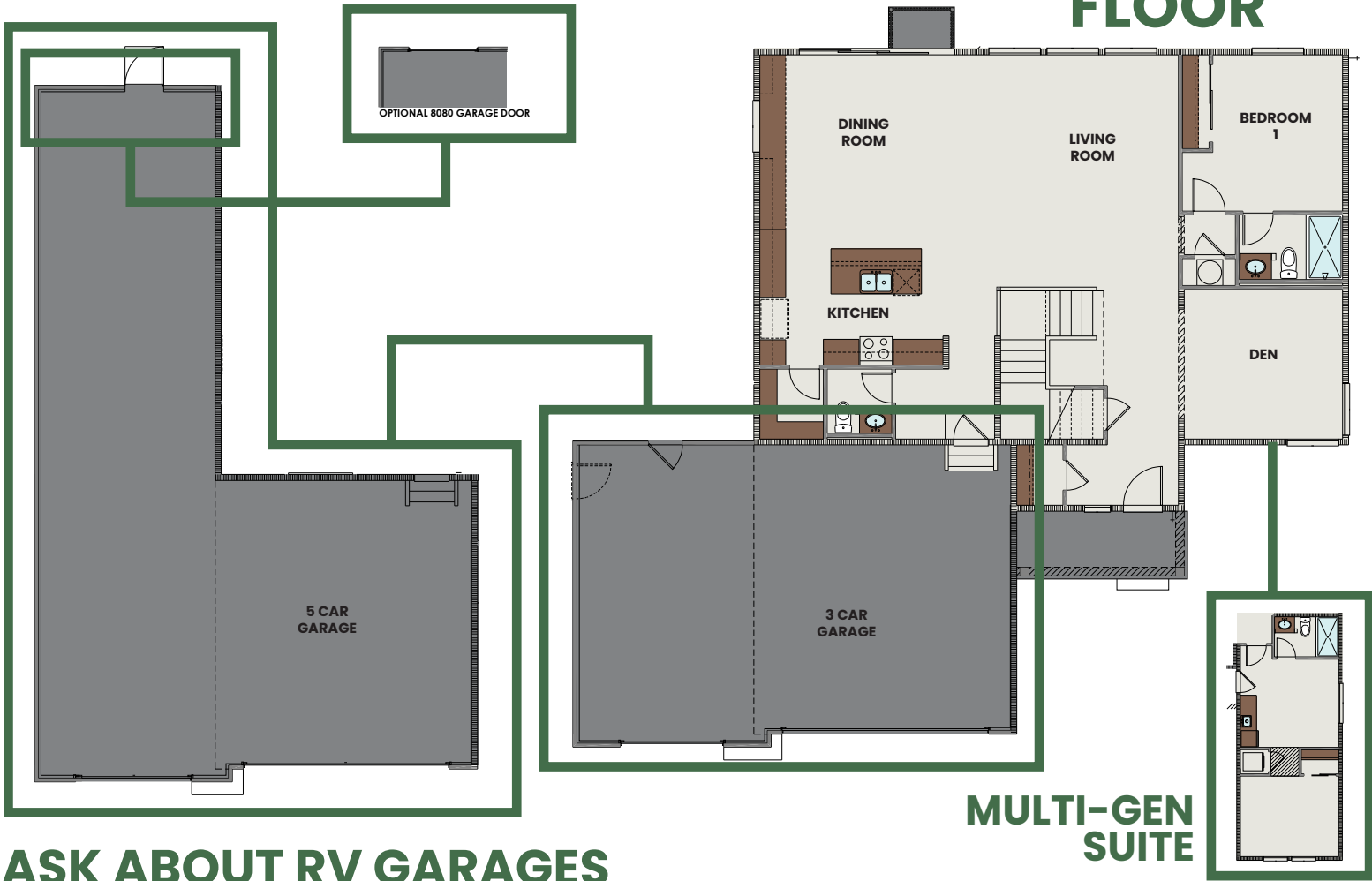

ASK ABOUT RV GARAGES

# SECOND FLOOR

